

TOP JAMB INSTALLATION CLOSER MOUNTED TOP JAMB ON PUSH SIDE OF DOOR

GENERAL LOCK CX7000 Series

STANDARD INSTALLATION CLOSER MOUNTED ON PULL SIDE OF DOOR

GENERAL LOCK CX7000 Series

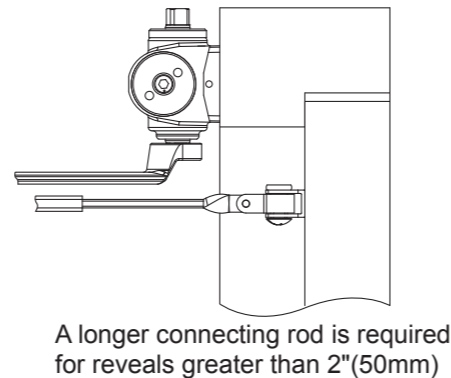
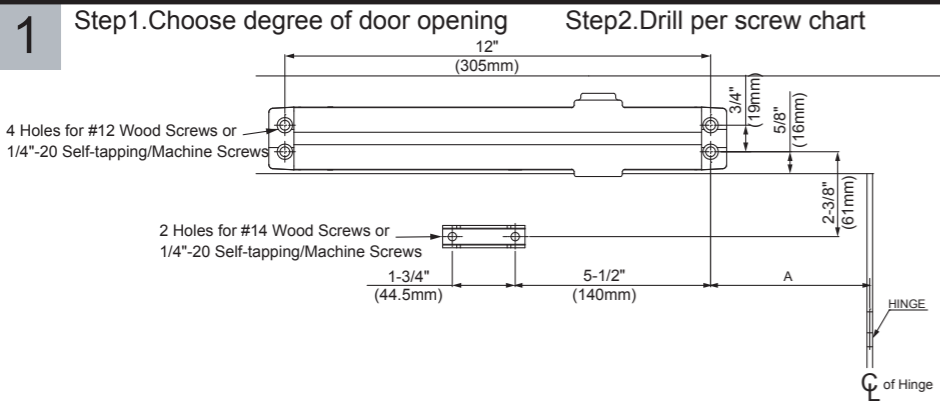

RIGHT HAND DOOR ILLUSTRATED

Opening	Dimensions "A"
To 100°	7-1/2" (191 mm)
To 130°	6" (152 mm)
To 180°	4-1/2" (114 mm)

Adjust spring power to match chart

Opening	Closer Size	Number of Turns	Closer Size	Number of Turns
To 100°	Size 3	0	Size 6	+12
	Size 2	-5	Size 5	+9
	Size 1	-9	Size 4	+4
To 130°	Size 3	0	Size 6	+14
	Size 2	-4	Size 5	+10
	Size 1	-9	Size 4	+5
To 180°	Size 3	0		
	Size 2	-5	Size 5	+10
	Size 1 /	-10 / -11	Size 4	+5

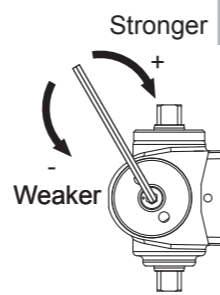

Do not turn past 12 turns. Door Closer Size I is not covered by CAN/ULC S133 since it is not intended for use with swinging doors in fire separations and on exit doors.

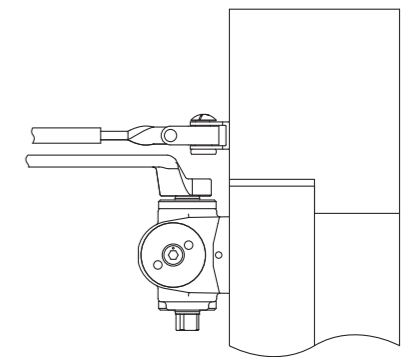
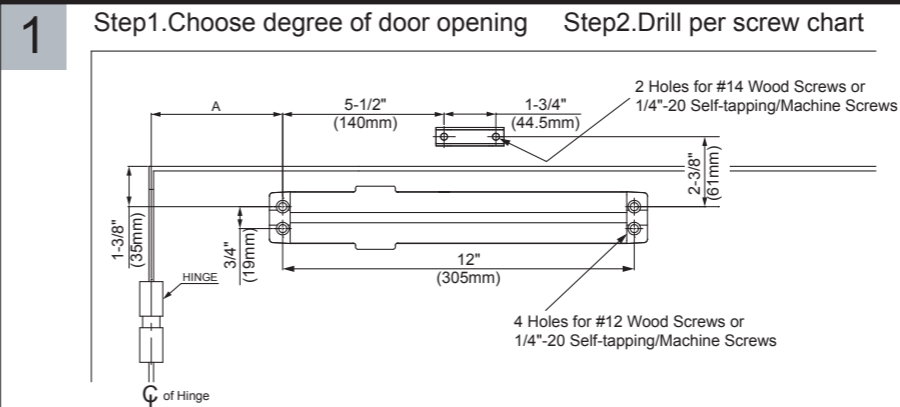

RIGHT HAND DOOR ILLUSTRATED

Opening	Dimensions "A"
To 100°	7-1/2" (191 mm)
To 130°	6" (152 mm)
To 180°	4-1/2" (114 mm)

Adjust spring power to match chart

Opening	Closer Size	Number of Turns	Closer Size	Number of Turns
To 100°	Size 3	0	Size 6	+12
	Size 2	-5	Size 5	+9
	Size 1	-9	Size 4	+4
To 130°	Size 3	0	Size 6	+14
	Size 2	-4	Size 5	+10
	Size 1	-9	Size 4	+5
To 180°	Size 3	0		
	Size 2	-5	Size 5	+10
	Size 1 /	-10 / -11	Size 4	+5

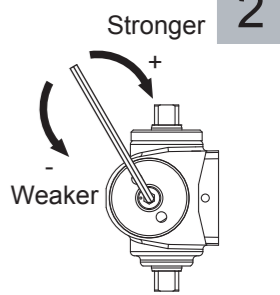

Do not turn past 12 turns. Door Closer Size I is not covered by CAN/ULC S133 since it is not intended for use with swinging doors in fire separations and on exit doors.

3 Step1→Step2→Step3→Step4→Step5→Step6→Step7

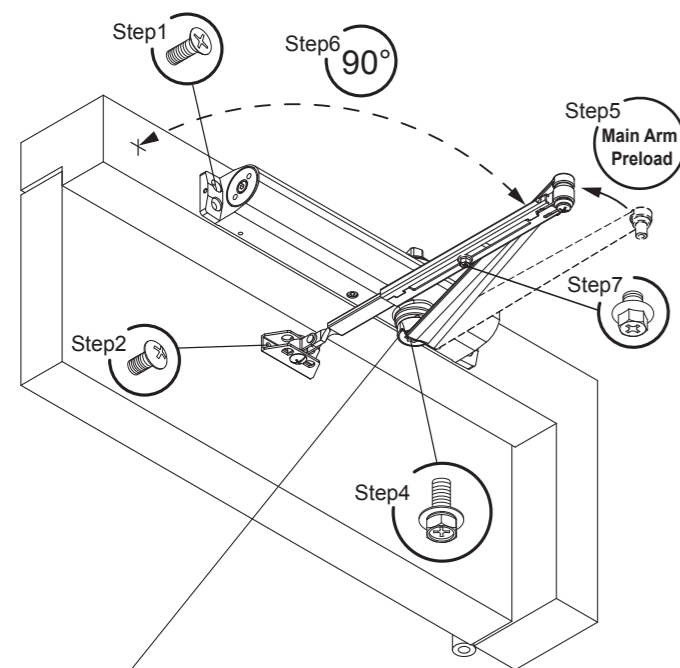

Right Hand Door Illustrated

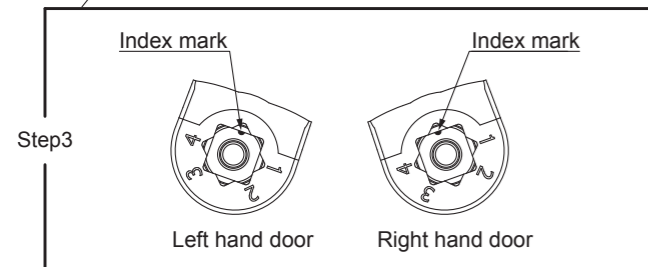

4

Adjustment Order

- #1 - Power Adjustment
- #2 - Back Check Adjustment
- #3 - Delay Action Adjustment (If Equipped)
- #4 - Sweep Adjustment
- #5 - Latch Adjustment

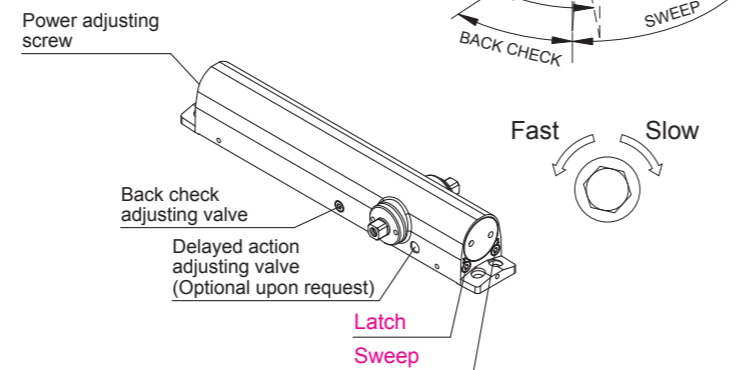

5 Plastic Cover

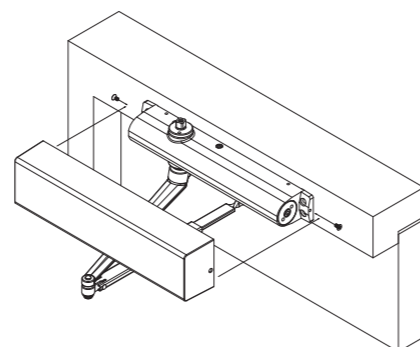

3 Step1→Step2→Step3→Step4→Step5→Step6→Step7

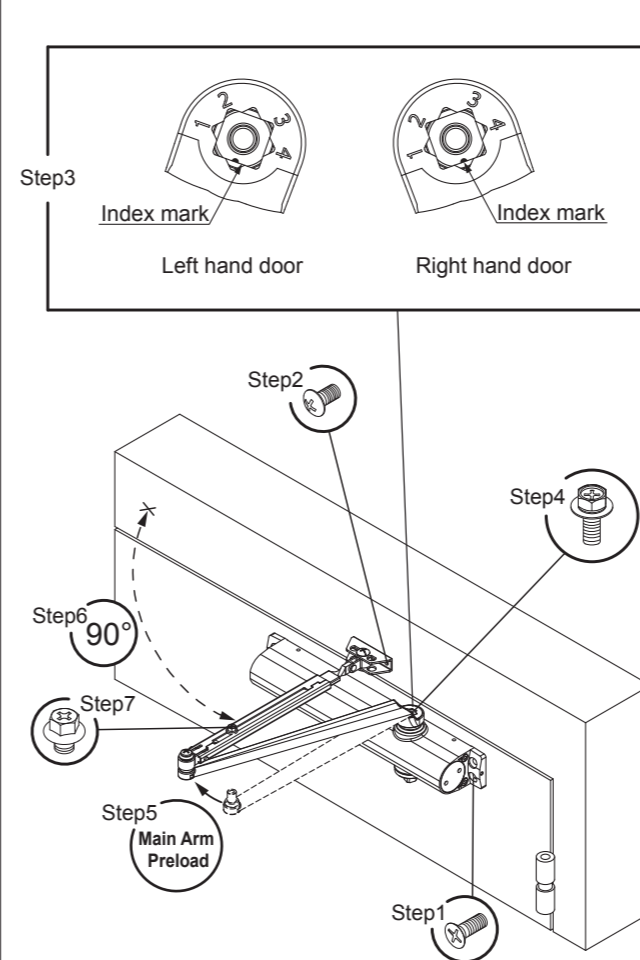

Left Hand Door Illustrated

4

Adjustment Order

- #1 - Power Adjustment
- #2 - Back Check Adjustment
- #3 - Delay Action Adjustment (If Equipped)
- #4 - Sweep Adjustment
- #5 - Latch Adjustment

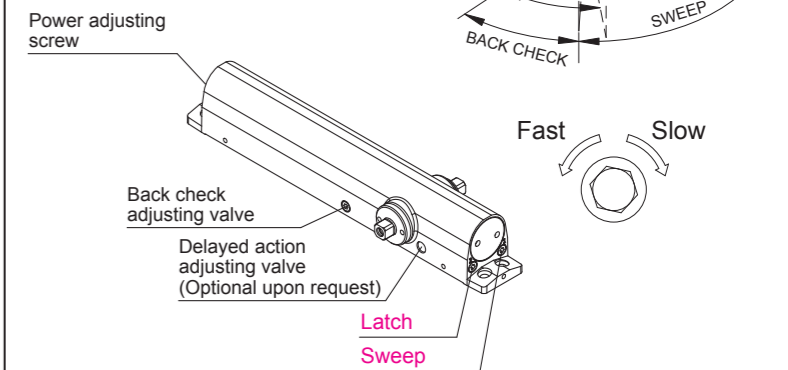

5 Plastic Cover

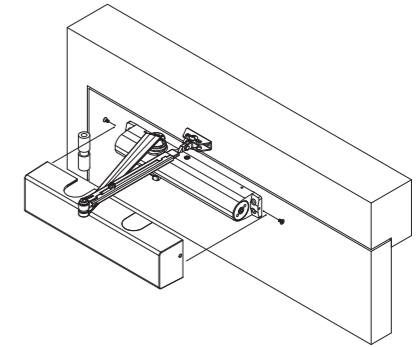

PARALLEL ARM INSTALLATION CLOSER MOUNTED ON PUSH SIDE OF DOOR

GENERAL LOCK CX7000 Series

GENERAL LOCK CX7000 Series

1 Step1.Choose degree of door opening Step2.Drill per screw chart.

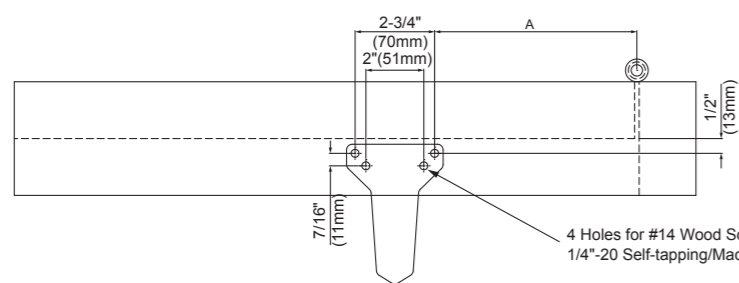

RIGHT HAND DOOR ILLUSTRATED

Opening	Dimensions "A"	Dimensions "B"
To 120°	9-1/2"(241mm)	3-3/4"(95mm)
To 180°	7"(178mm)	1-1/4"(32mm)

4 Holes for #14 Wood Screws or 1/4"-20 Self-tapping/Machine Screws
4 Holes for #12 Wood Screws or 1/4"-20 Self-tapping/Machine Screws

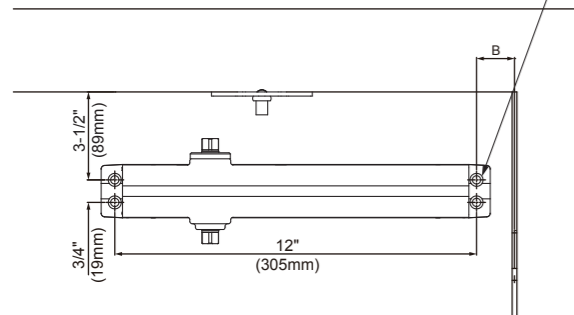

Adjust spring power to match chart.

Opening	Closer Size	Number of Turns	Closer Size	Number of Turns
To 120°	Size 3	0	Size 5	+13
	Size 2	-5	Size 4	+6
	Size 1	-11		
To 180°	Size 3	0		
	Size 2	-4	Size 5	+13
	Size 1	-10	Size 4	+7

Do not turn past 13 turns. Door Closer Size 1 is not covered by CAN/ULC S133 since it is not intended for use with swinging doors in fire separations and on exit doors.

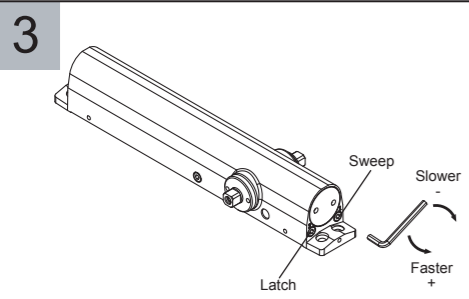
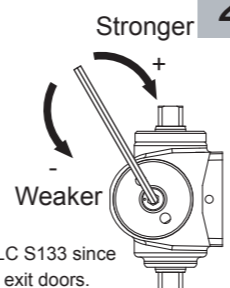

4 Step1→Step2→Step3

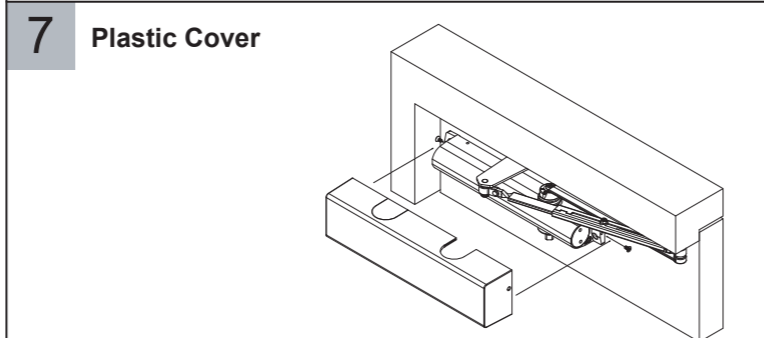
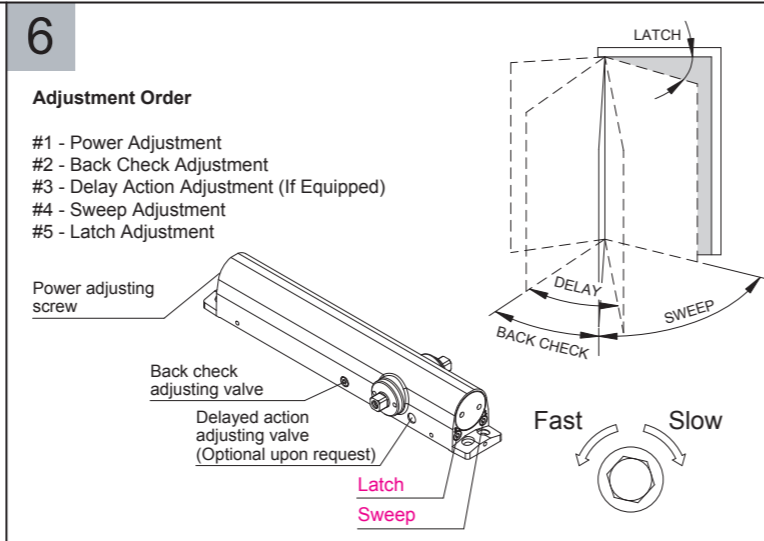
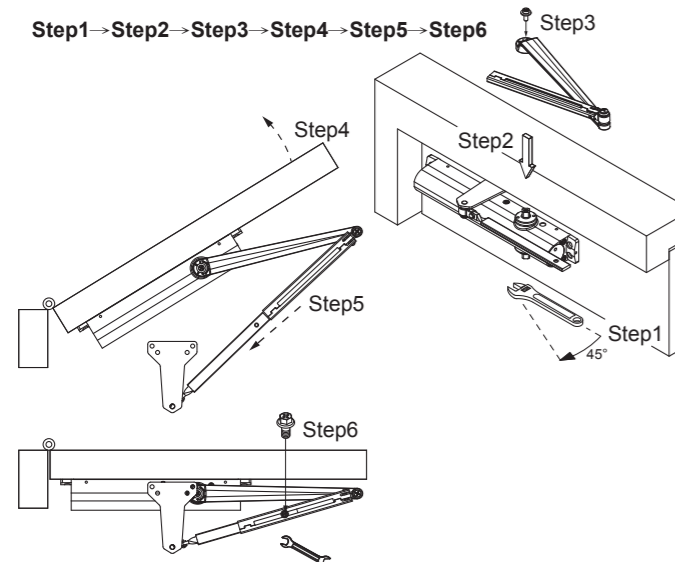
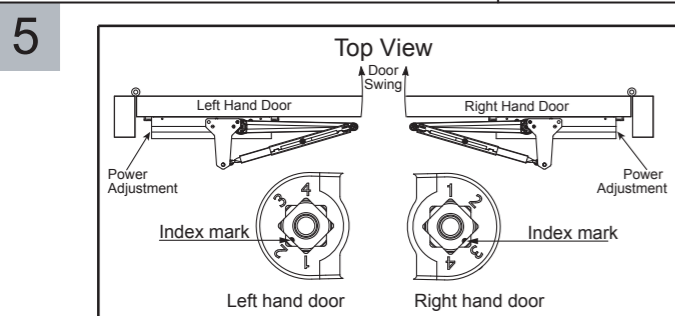
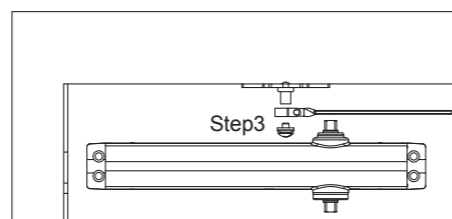
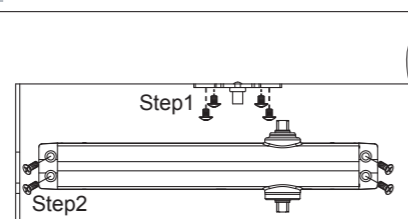

ANSI Recommended Method for Measuring Force Compliance to ADA

1. On the push side of the door, locate a point on the horizontal center line of the push plate or lock trim, at 1 inch (mm) from the latch edge of the door.
2. Mark the floor at a point where the push side of the door's latch stile is at 70 degrees. Mark a second point where the push side is 3 inches from the latch.
3. Open the door so the latch is clear of the strike and the door is slightly off the stop.
4. Using a force gauge on the mark determined in Step 1, gradually push the door open to the 70-degree mark established in Step 2. Observe the maximum force reading.

Pull Side Installation

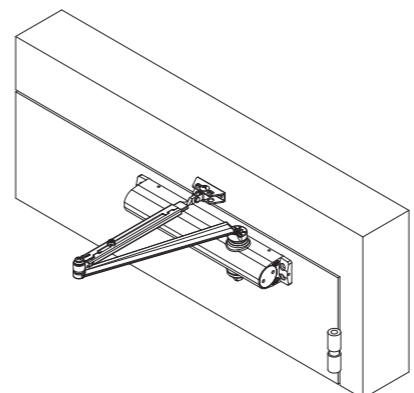

Push Side Installation

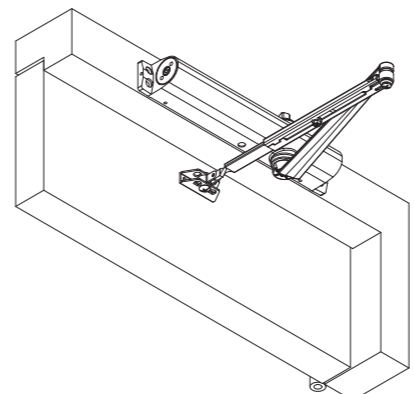

Parallel Arm Installation

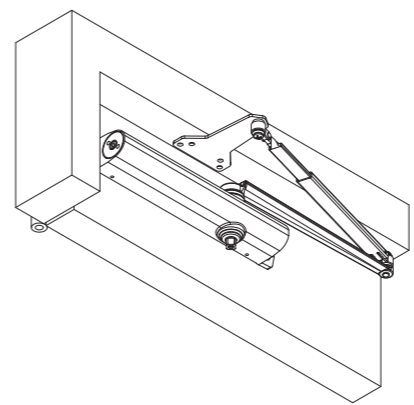

DOOR CLOSER INSTALLATION INSTRUCTION

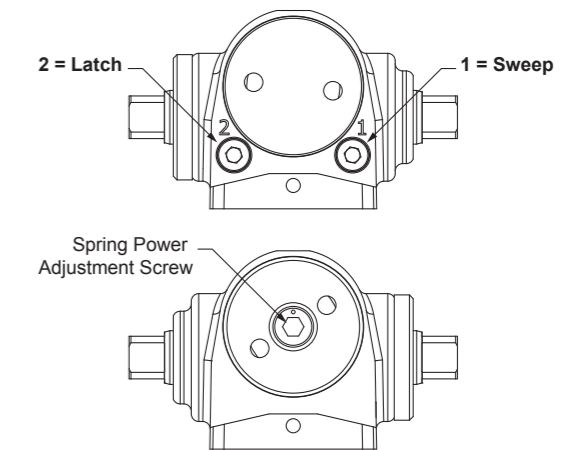

Power Adjustment Chart	DOOR	INTERIOR		EXTERIOR	
	TYPE OF INST.	Regular Arm Top Jamb	Parallel Arm	Regular Arm Top Jamb	Parallel Arm
Number of Turns Required DOOR SIZE (INCHES)	24" - 30" (61 cm - 76 cm)	-11	-3	-4	0
	30" - 34" (76 cm - 86 cm)	-5	0	0	7
	34" - 38" (86 cm - 97 cm)	0	5	6	13
	38" - 48" (97 cm - 122 cm)	5	10	12	
	48" - 54" (122 cm - 137 cm)	10	15		
	54" - 60" (137 cm - 152 cm)	15			

Do not turn past 15 turns.
NOTE: Maximum of 26 turns (360°) of power adjustment nut.
Closer is shipped at 11 turns from the factory.

Standard Components

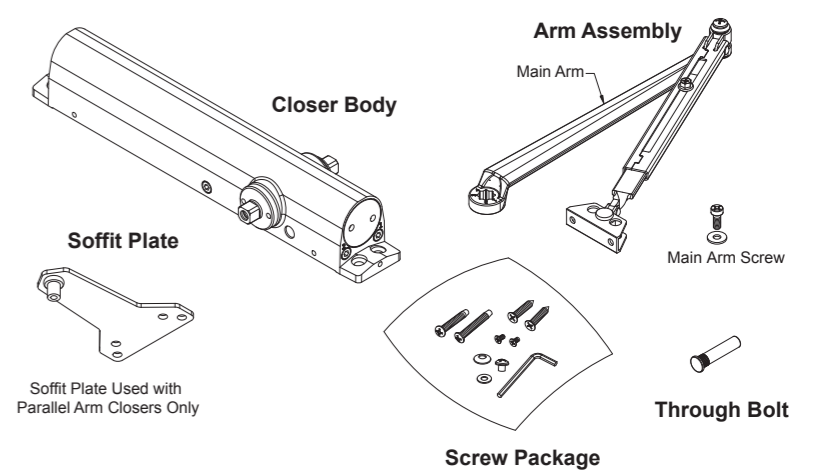

Plastic Cover

